

# Border Galleries (First Floor): Tells the story of Carlisle from Prehistory to the present day.

This is a changing exhibition space - come and see what's on at the moment!

Toddler Area: games, books and costumes for big people and little ones

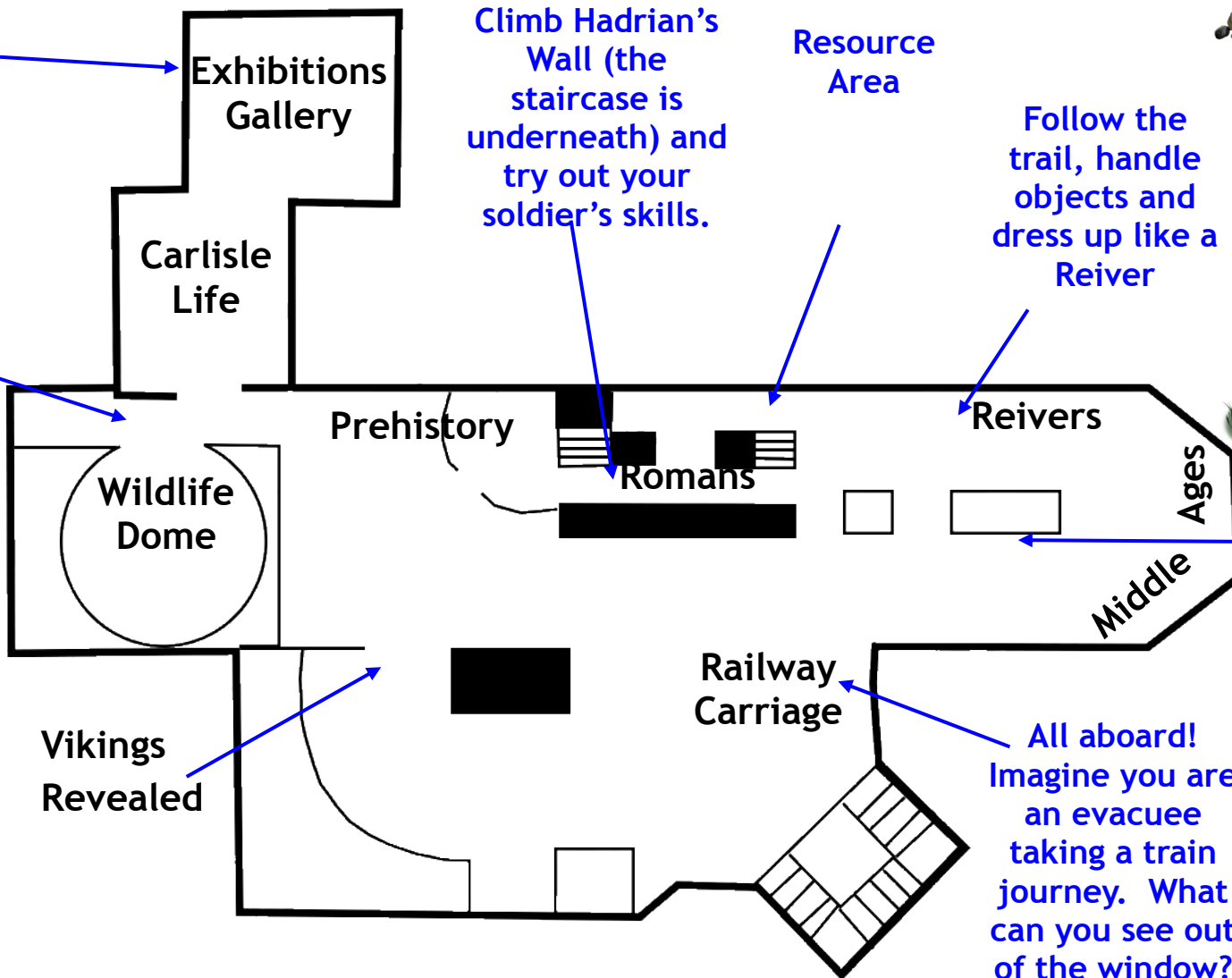

Climb Hadrian's Wall (the staircase is underneath) and try out your soldier's skills.

Resource Area

Follow the trail, handle objects and dress up like a Reiver



Have a go in our stocks

All aboard! Imagine you are an evacuee taking a train journey. What can you see out of the window?



# Roman Frontier Gallery (Lower Level)

Our award winning Roman Frontier Gallery explores life in Roman Carlisle. This gallery is full of interactives so get stuck in!

Have a look out for our interactive games on the computers - dress the Romans and try out the jigsaw.

Have a go at building your own Hadrian's Wall

Visit our Collections Conversations desk and handle real Roman objects

Have a sniff - we dare you!

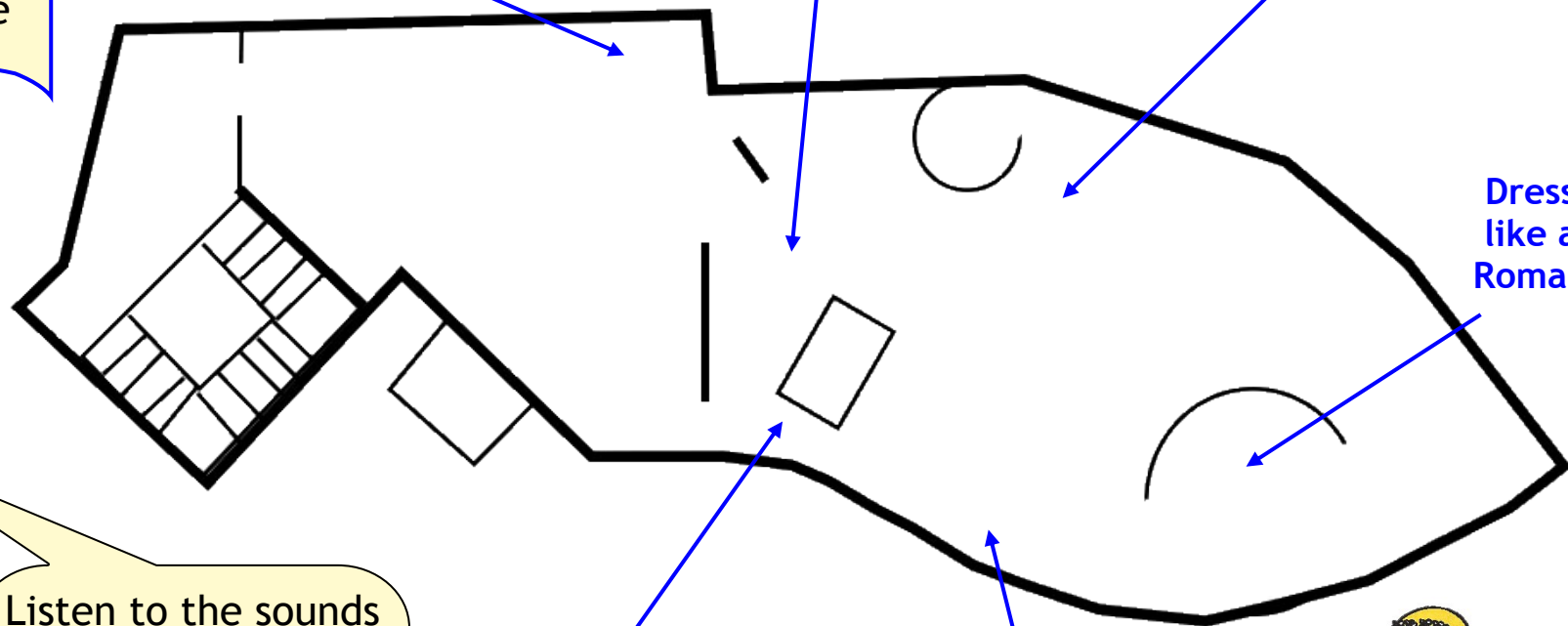

Dress like a Roman



Listen to the sounds on the stairs! As you go down they change from the voices of modern to Roman Carlisle!

Could you be a Roman soldier? Explore our tent and find out!

Discover our Roman skeleton and find out where he was buried

